

FOR SUB-LEASE

High Traffic Retail Suite

TERRI THIELST
O: 805.688.5333 / C: 805.680.2279
terri@BattagliaRE.com

Frederik's Court

485 Alisal Rd Suite 120

SOLVANG, CA



- Excellent visibility
- Picturesque and inviting courtyard
- Ideal for gifts, clothiers, and wine tasting

Prime retail suite available for sub-lease. Excellent downtown location on busy corner of Alisal Road and Mission Drive in the Danish town of Solvang. Highway frontage with 19,000 car trips per day on Mission Drive and high volume pedestrian traffic. Beautifully landscaped and a great tenant atmosphere. Call for details.

PROPERTY & LEASE DETAILS

Lease Rate: \$2,950/month
Lease Term: Through March 31, 2019
Suite Size: Approx. 1,600 SF
Floors: 1st and 2nd
Storage: Separate 100 SF storage room
Zoning: TRC Tourist Related Commercial
Renovated: 2007
Restrooms: Common & Private
Parking: 16 spaces on-site plus
public lot across the street
Elevator: Yes, for whole building

FOR LEASE: Frederik's Court, 485 Alisal Rd #120, Solvang, CA

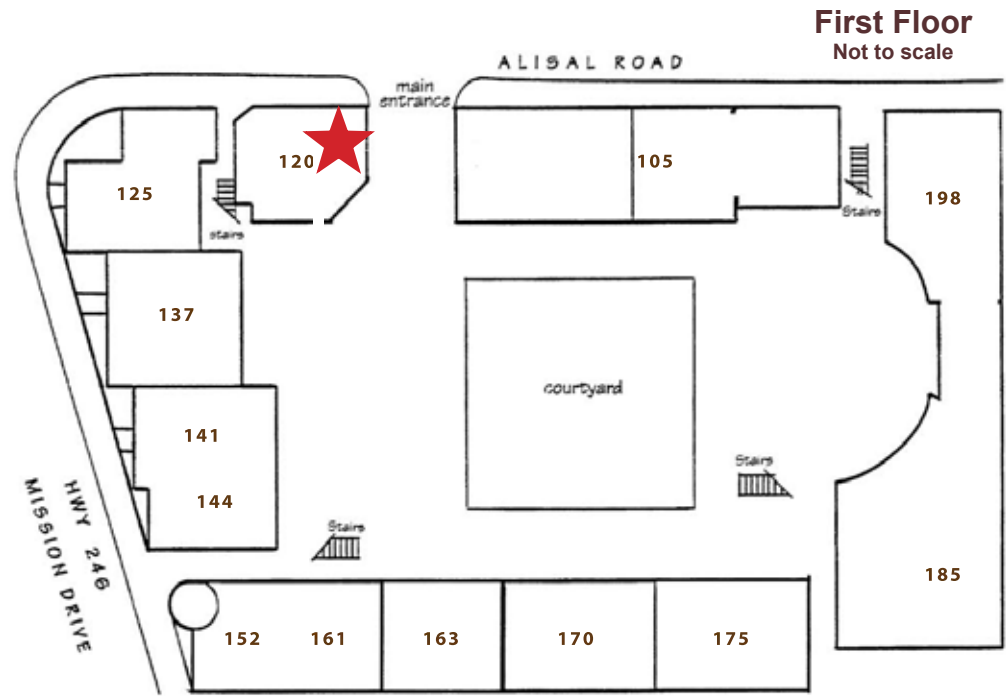

The information contained in this flyer has been obtained from sources believed reliable. While we do not doubt its accuracy, we do not guarantee it.



The information contained in this flyer has been obtained from sources believed reliable. While we do not doubt its accuracy, we do not guarantee it.